

## I SERIES "AF/CF" WITH SPRING LOADED

BALL TRANSFER UNITS WITH EXTERNAL HOUSING MADE OF BURNISHED STEEL  
 OILED FELT SEALING SYSTEM INCORPORATED  
 SELF CLEANING HOLE INCOPORATED IN ALL UNITS  
 BALL TRANSFER UNIT MOUNTING BY REMOVABLE FIXING CLIP FOR EVENTUAL MANTENAINCE  
 WORKING TEMPERATURE : -20°C +100 °

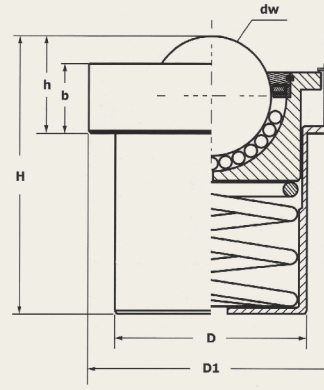

TYPE	Features	Dw	D	Tol	D1	h	H	b	Kg Loading Capacity	Kg Pre load	TOLER Pre-load %	Kg Weight
SPM 22 AF	EXTERNAL HOUSING MADE OF BURNISHED STEEL, ZINC PLATED MACHINED BODY AND STEEL BALLS	22	39	± 0,1	50	18,5	58	14	80	7,5	+25/-7,5	0,36
SPM 30 AF		30	48,5	± 1,2	62	24,5	70	17,5	150	13,5	+15/-7,5	0,68
SPM 45 AF		45	66,5	±1,5	85	36	100,5	25,5	215	23	+15/-7,5	1,90
SPM 22 CF	EXTERNAL HOUSING MADE OF BURNISHED STEEL, ZINC PLATED MACHINED BODY AND STAINLESS	22	39	± 0,1	50	18,5	58	14	80	7,5	+25/-7,5	0,36
SPM 30 CF		30	48,5	± 1,2	62	24,5	70	17,5	150	13,5	+15/-7,5	0,68
SPM 45 CF		45	66,5	±1,5	85	36	100,5	25,5	215	23	+15/-7,5	1,90

 Load Up  Load Down

